



Blood Transfer Unit

Instructions for use



Intended Use: The Blood Transfer Unit is used to transfer blood from a syringe into to the evacuated blood collection tube.

Product Description: The Blood Transfer Unit is a single-use, sterile, blood collection accessory. The design of the device allows collection of blood from a syringe into a blood collection tube.

Precautions/Cautions

Precautions

1. Check Blood Transfer Unit before use.
2. Do not use device when the product or packaging is damaged!
3. Any Blood Transfer Unit that becomes contaminated with blood is considered hazardous and must be disposed of immediately.
4. Never touch the inside of the holder to prevent risk of needlestick injury.
5. The handling of Blood Transfer Unit must be in accordance to the policies and procedures of your facility.
6. HBV, HCV, HIV and other infectious diseases can be transmitted through contact with biological samples. In the event of exposure to biological samples, ensure that appropriate medical attention is obtained.
7. Do not use Blood Transfer Unit after its expiry date.
8. Handle all biological samples and blood collection "sharps" (lancets, needles, Luer adapters, and blood collection sets) according to the policies and procedures of your facility.
9. Discard all blood collection "sharps" in biohazard containers approved for their disposal.
10. Gloves should be worn at all times during venipuncture and sample transfer to evacuated tubes to minimize exposure hazard.

Storage

Store transfer devices at 4–25°C (40–77° F).

NOTE: Avoid exposure to direct sunlight. Exceeding the maximum recommended storage temperature may lead to impairment of the device.

Handling Procedures

READ THIS ENTIRE CIRCULAR BEFORE PERFORMING VENIPUNCTURE.

WEAR GLOVES DURING VENIPUNCTURE AND WHEN HANDLING BLOOD COLLECTION TUBES TO MINIMISE EXPOSURE HAZARD!



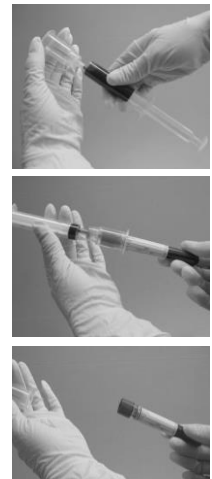





1. Open the blister packaging and fully remove device from packaging.
NOTE: The blister packaging is an indicator of sterility and product integrity. If the blister packaging is broken or damaged, dispose of the Blood Transfer Unit and select another.
2. Draw the blood into the syringe using your institution's procedure.
3. Disconnect the needle from the syringe, and dispose of needle immediately in biohazard or sharps container.
4. Select blood collection tube or tubes appropriate for required specimen.
5. Firmly attach a Blood Transfer Unit to the syringe.
6. Insert a VACUETTE® blood collection tube into the Blood Transfer Unit, fully penetrating the tube stopper and hold it in place.
7. Allow the blood to transfer freely from the syringe to the tube. To ensure the proper blood to additive ratio in the tube, use the fill line on the label as a visual control.
NOTE: Do not press the plunger of the syringe! The vacuum in the tube will draw the blood from the syringe into the tube.
8. When the first tube is full and blood flow ceases, gently remove it from the Blood Transfer Unit.
9. Place succeeding tubes in holder, following the recommended order of draw.
10. Gently invert the tubes immediately after blood transfer to mix additive and blood.
11. Dispose of the syringe and the Blood Transfer Unit as one piece according to your institution's policies.



Disposal

The general hygiene guidelines and legal regulations for the proper disposal of infectious material should be considered and followed.

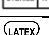
Label Information on the packaging.

	Item number		Do Not Reuse
	LOT number: Batch number		Consult Instructions For Use
	Expiry Date.		Manufactured by
	Sterilization Using Irradiation		Temperature Limit
	Contains Dry Natural Rubber		

This Product Contains Dry Natural Rubber

References

GP41-A6 "procedures for the Collection of Diagnostic Blood Specimens by Venipuncture; Approved Standard 6th Edition"
M29-A3 "Protection of Laboratory Workers from Occupationally acquired Infections; Approved Guideline – 3rd Edition"



Greiner Bio-One GmbH
Bad Haller Str. 32,
4550 Kremsmünster, Austria